

PRESA DI FORZA A COMANDO PNEUMATICO

PNEUMATIC CLUTCH POWER TAKE-OFF

CODICE PTO
PTO CODE

16-16-179

CAMBIO
GEARBOX

MERCEDES



DIAGRAMMA DI UTILIZZO WORKING CONDITION



Data: Martedì 20 dicembre 2011

Codice foglio: 997-216-01617 Rev: AA

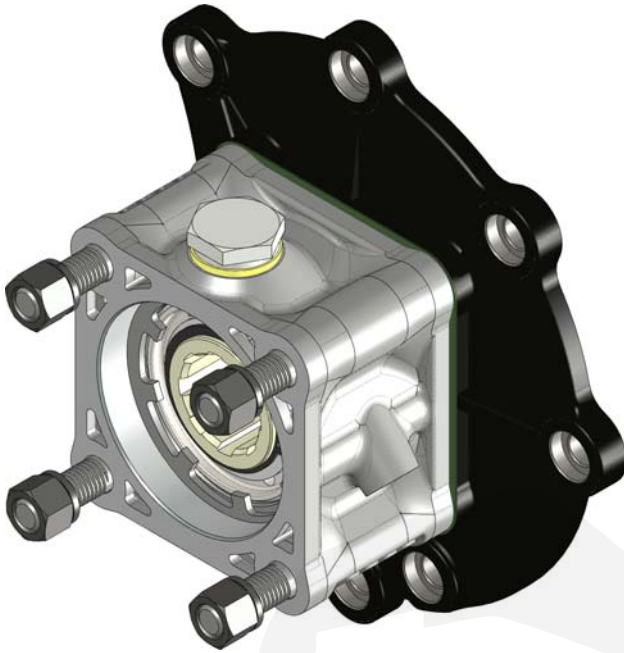
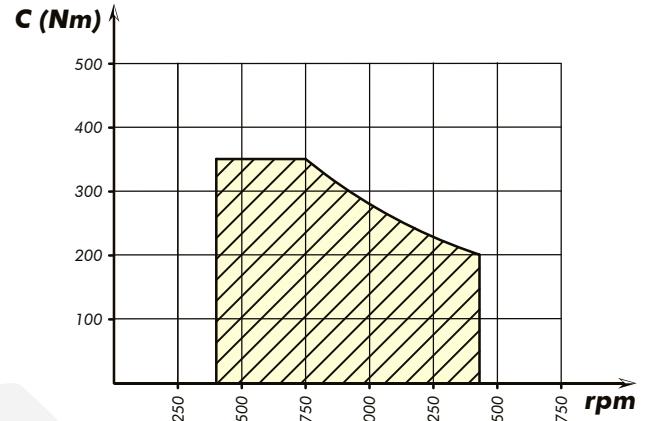
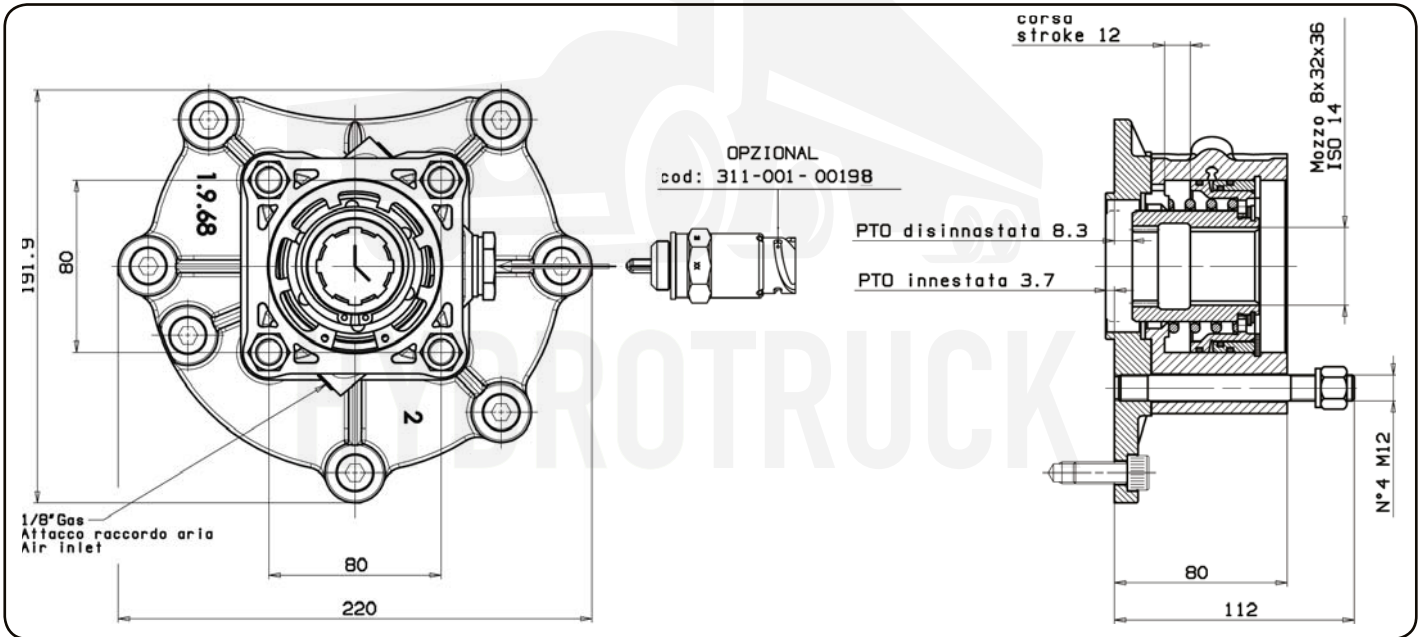

Tipo cambio Gearbox	Codice PTO PTO code	Versione Version	Giri pto a 1000 giri motore Pto ratio@1000 eng.rpm	Coppia massima Max torque	Lato montaggio Mounting side	Uscita Output	Rotazione Rotation	Kit di montaggio Mounting kit	Peso Weight
			rpm	Nm					kg
G 60-6/9,2	16-16-179	17	450	350	Post. Rear	Poster. Rear	Oraria Cw	154-3-3455	4,2
G85-6/6,70			620						



www.hydrotruck.cz
info@hydrotruck.cz

Hydrotruck s.r.o.
Tovačovská 3457/4a
750 02, Přešov
Česká republika

COMPANY WITH
QUALITY SYSTEM
CERTIFIED BY DNV GL
= ISO 9001:2015 =