

| Codice Code               | K    | Z    | kg    | E BSP | ØP | H | V | M | H1 | V1 | M1 | Code A | Code B | Codice Code               | K    | Z    | kg    |
|---------------------------|------|------|-------|-------|----|---|---|---|----|----|----|--------|--------|---------------------------|------|------|-------|
| <b>ØD 42 ØAL 32 ØS 20</b> |      |      |       |       |    |   |   |   |    |    |    |        |        |                           |      |      |       |
| HMC032200050              | 50   | 195  | 1,45  |       |    |   |   |   |    |    |    |        |        |                           |      |      |       |
| HMC032200100              | 100  | 245  | 1,80  |       |    |   |   |   |    |    |    |        |        |                           |      |      |       |
| HMC032200150              | 150  | 295  | 2,15  |       |    |   |   |   |    |    |    |        |        |                           |      |      |       |
| HMC032200200              | 200  | 345  | 2,50  |       |    |   |   |   |    |    |    |        |        |                           |      |      |       |
| HMC032200250              | 250  | 395  | 2,85  |       |    |   |   |   |    |    |    |        |        |                           |      |      |       |
| HMC032200300              | 300  | 445  | 3,20  |       |    |   |   |   |    |    |    |        |        |                           |      |      |       |
| HMC032200400              | 400  | 545  | 3,90  |       |    |   |   |   |    |    |    |        |        |                           |      |      |       |
| HMC032200500              | 500  | 645  | 4,60  |       |    |   |   |   |    |    |    |        |        |                           |      |      |       |
| <b>ØD 50 ØAL 40 ØS 20</b> |      |      |       |       |    |   |   |   |    |    |    |        |        | <b>ØD 50 ØAL 40 ØS 25</b> |      |      |       |
| HMC1200100                | 100  | 280  | 2,63  |       |    |   |   |   |    |    |    |        |        | HMC1250100                | 100  | 280  | 2,80  |
| HMC1200150                | 150  | 330  | 3,03  |       |    |   |   |   |    |    |    |        |        | HMC1250150                | 150  | 330  | 3,23  |
| HMC1200200                | 200  | 380  | 3,43  |       |    |   |   |   |    |    |    |        |        | HMC1250200                | 200  | 380  | 3,74  |
| HMC1200250                | 250  | 430  | 3,83  |       |    |   |   |   |    |    |    |        |        | HMC1250250                | 250  | 430  | 4,21  |
| HMC1200300                | 300  | 480  | 4,23  |       |    |   |   |   |    |    |    |        |        | HMC1250300                | 300  | 480  | 4,68  |
| HMC1200350                | 350  | 530  | 4,63  |       |    |   |   |   |    |    |    |        |        | HMC1250350                | 350  | 530  | 5,15  |
| HMC1200400                | 400  | 580  | 5,03  |       |    |   |   |   |    |    |    |        |        | HMC1250400                | 400  | 580  | 5,62  |
| HMC1200450                | 450  | 630  | 5,43  |       |    |   |   |   |    |    |    |        |        | HMC1250450                | 450  | 630  | 6,09  |
| HMC1200500                | 500  | 680  | 5,83  |       |    |   |   |   |    |    |    |        |        | HMC1250500                | 500  | 680  | 6,55  |
|                           |      |      |       |       |    |   |   |   |    |    |    |        |        | HMC1250550                | 550  | 730  | 7,02  |
|                           |      |      |       |       |    |   |   |   |    |    |    |        |        | HMC1250600                | 600  | 780  | 7,49  |
| <b>ØD 60 ØAL 50 ØS 25</b> |      |      |       |       |    |   |   |   |    |    |    |        |        | <b>ØD 60 ØAL 50 ØS 30</b> |      |      |       |
| HMC2250100                | 100  | 309  | 4,24  |       |    |   |   |   |    |    |    |        |        | HMC2300100                | 100  | 309  | 4,44  |
| HMC2250150                | 150  | 359  | 4,27  |       |    |   |   |   |    |    |    |        |        | HMC2300150                | 150  | 359  | 5,06  |
| HMC2250200                | 200  | 409  | 5,30  |       |    |   |   |   |    |    |    |        |        | HMC2300200                | 200  | 409  | 5,67  |
| HMC2250250                | 250  | 459  | 5,82  |       |    |   |   |   |    |    |    |        |        | HMC2300250                | 250  | 459  | 6,29  |
| HMC2250300                | 300  | 509  | 6,36  |       |    |   |   |   |    |    |    |        |        | HMC2300300                | 300  | 509  | 6,90  |
| HMC2250350                | 350  | 559  | 6,88  |       |    |   |   |   |    |    |    |        |        | HMC2300350                | 350  | 559  | 7,52  |
| HMC2250400                | 400  | 609  | 7,41  |       |    |   |   |   |    |    |    |        |        | HMC2300400                | 400  | 609  | 8,13  |
| HMC2250450                | 450  | 659  | 7,94  |       |    |   |   |   |    |    |    |        |        | HMC2300450                | 450  | 659  | 8,74  |
| HMC2250500                | 500  | 709  | 8,47  |       |    |   |   |   |    |    |    |        |        | HMC2300500                | 500  | 709  | 9,36  |
| HMC2250550                | 550  | 759  | 9,00  |       |    |   |   |   |    |    |    |        |        | HMC2300550                | 550  | 759  | 9,98  |
| HMC2250600                | 600  | 809  | 9,53  |       |    |   |   |   |    |    |    |        |        | HMC2300600                | 600  | 809  | 10,59 |
| HMC2250700 <b>NEW!</b>    | 700  | 909  | 10,65 |       |    |   |   |   |    |    |    |        |        | HMC2300700                | 700  | 909  | 11,82 |
| HMC2250800                | 800  | 1009 | 11,65 |       |    |   |   |   |    |    |    |        |        | HMC2300800                | 800  | 1009 | 13,05 |
| HMC2251000                | 1000 | 1209 | 13,77 |       |    |   |   |   |    |    |    |        |        | HMC2301000                | 1000 | 1209 | 15,50 |
| <b>ØD 70 ØAL 60 ØS 30</b> |      |      |       |       |    |   |   |   |    |    |    |        |        | <b>ØD 70 ØAL 60 ØS 35</b> |      |      |       |
| HMC3300100                | 100  | 329  | 5,83  |       |    |   |   |   |    |    |    |        |        | HMC3350100                | 100  | 329  | 6,08  |
| HMC3300150                | 150  | 379  | 6,50  |       |    |   |   |   |    |    |    |        |        | HMC3350150                | 150  | 379  | 6,86  |
| HMC3300200                | 200  | 429  | 7,18  |       |    |   |   |   |    |    |    |        |        | HMC3350200                | 200  | 429  | 7,64  |
| HMC3300250                | 250  | 479  | 7,86  |       |    |   |   |   |    |    |    |        |        | HMC3350250                | 250  | 479  | 8,40  |
| HMC3300300                | 300  | 529  | 8,53  |       |    |   |   |   |    |    |    |        |        | HMC3350300                | 300  | 529  | 9,19  |
| HMC3300350                | 350  | 579  | 9,21  |       |    |   |   |   |    |    |    |        |        | HMC3350350                | 350  | 579  | 9,96  |
| HMC3300400                | 400  | 629  | 9,88  |       |    |   |   |   |    |    |    |        |        | HMC3350400                | 400  | 629  | 10,74 |
| HMC3300450                | 450  | 679  | 10,56 |       |    |   |   |   |    |    |    |        |        | HMC3350450                | 450  | 679  | 11,52 |
| HMC3300500                | 500  | 729  | 11,23 |       |    |   |   |   |    |    |    |        |        | HMC3350500                | 500  | 729  | 12,29 |
| HMC3300550                | 550  | 779  | 11,91 |       |    |   |   |   |    |    |    |        |        | HMC3350550                | 550  | 779  | 13,07 |
| HMC3300600                | 600  | 829  | 12,58 |       |    |   |   |   |    |    |    |        |        | HMC3350600                | 600  | 829  | 13,84 |
| HMC3300700 <b>NEW!</b>    | 700  | 929  | 14,04 |       |    |   |   |   |    |    |    |        |        | HMC3350700 <b>NEW!</b>    | 700  | 929  | 15,48 |
| HMC3300800                | 800  | 1029 | 15,29 |       |    |   |   |   |    |    |    |        |        | HMC3350800                | 800  | 1029 | 16,95 |
| HMC3301000                | 1000 | 1229 | 17,99 |       |    |   |   |   |    |    |    |        |        | HMC3351000                | 1000 | 1229 | 20,05 |

CILINDRO DOPPIO EFFETTO STANDARD CON ATTACCHI  
DOUBLE ACTING CYLINDER WITH ENDS

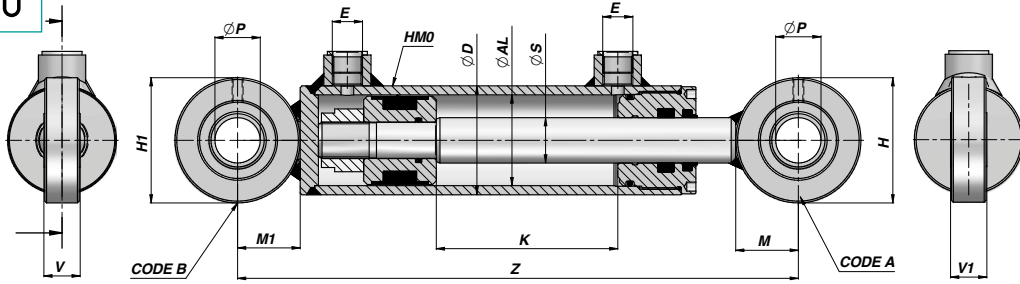

Series M250



| Codice Code                 | K    | Z    | kg    | E BSP | ØP | H   | V  | M    | H1  | V1 | M1   | Code A        | Code B        | Codice Code                 | K    | Z    | kg    |  |
|-----------------------------|------|------|-------|-------|----|-----|----|------|-----|----|------|---------------|---------------|-----------------------------|------|------|-------|--|
| <b>ØD 70 ØAL 60 ØS 40</b>   |      |      |       |       |    |     |    |      |     |    |      |               |               | <b>ØD 73 ØAL 63 ØS 40</b>   |      |      |       |  |
| HMC3400200                  | 200  | 429  | 8,26  |       |    |     |    |      |     |    |      |               |               | HMC063400200                | 200  | 429  | 8,57  |  |
| HMC3400250                  | 250  | 479  | 9,17  |       |    |     |    |      |     |    |      |               |               | HMC063400250                | 250  | 479  | 9,48  |  |
| HMC3400300                  | 300  | 529  | 10,06 |       |    |     |    |      |     |    |      |               |               | HMC063400300                | 300  | 529  | 10,29 |  |
| HMC3400350                  | 350  | 579  | 10,95 |       |    |     |    |      |     |    |      |               |               | HMC063400350                | 350  | 579  | 11,30 |  |
| HMC3400400                  | 400  | 629  | 11,84 |       |    |     |    |      |     |    |      |               |               | HMC063400400                | 400  | 629  | 12,21 |  |
| HMC3400450                  | 450  | 679  | 12,73 |       |    |     |    |      |     |    |      |               |               | HMC063400450                | 450  | 679  | 13,13 |  |
| HMC3400500                  | 500  | 729  | 13,63 | 3/8"  | 25 | 69  | 20 | 34,5 | 69  | 20 | 34,5 | CAGEG06904225 | CAGEG06904225 | HMC063400500                | 500  | 729  | 14,03 |  |
| HMC3400550                  | 550  | 779  | 14,52 |       |    |     |    |      |     |    |      |               |               | HMC063400550                | 550  | 779  | 14,86 |  |
| HMC3400600                  | 600  | 829  | 15,41 |       |    |     |    |      |     |    |      |               |               | HMC063400600                | 600  | 829  | 15,75 |  |
| HMC3400700 <b>NEW!</b>      | 700  | 929  | 17,28 |       |    |     |    |      |     |    |      |               |               | HMC063400700 <b>NEW!</b>    | 700  | 929  | 17,68 |  |
| HMC3400800                  | 800  | 1029 | 18,95 |       |    |     |    |      |     |    |      |               |               | HMC063400800                | 800  | 1029 | 19,48 |  |
| HMC3401000                  | 1000 | 1229 | 22,54 |       |    |     |    |      |     |    |      |               |               | HMC063401000                | 1000 | 1229 | 23,13 |  |
| <b>ØD 80 ØAL 70 ØS 35</b>   |      |      |       |       |    |     |    |      |     |    |      |               |               | <b>ØD 80 ØAL 70 ØS 40</b>   |      |      |       |  |
| HMC4350100                  | 100  | 335  | 7,25  |       |    |     |    |      |     |    |      |               |               | HMC4400100 <b>NEW!</b>      | 100  | 335  | 7,76  |  |
| HMC4350150                  | 150  | 385  | 8,09  |       |    |     |    |      |     |    |      |               |               | HMC4400150 <b>NEW!</b>      | 150  | 385  | 8,71  |  |
| HMC4350200                  | 200  | 435  | 8,95  |       |    |     |    |      |     |    |      |               |               | HMC4400200                  | 200  | 435  | 9,54  |  |
| HMC4350250                  | 250  | 485  | 9,76  |       |    |     |    |      |     |    |      |               |               | HMC4400250                  | 250  | 485  | 10,49 |  |
| HMC4350300                  | 300  | 535  | 10,60 |       |    |     |    |      |     |    |      |               |               | HMC4400300                  | 300  | 535  | 11,45 |  |
| HMC4350350                  | 350  | 585  | 11,46 |       |    |     |    |      |     |    |      |               |               | HMC4400350                  | 350  | 585  | 12,40 |  |
| HMC4350400                  | 400  | 635  | 12,27 |       |    |     |    |      |     |    |      |               |               | HMC4400400                  | 400  | 635  | 13,35 |  |
| HMC4350450                  | 450  | 685  | 13,13 | 3/8"  | 30 | 75  | 22 | 37,5 | 75  | 22 | 37,5 | CAGEG07504730 | CAGEG07504730 | HMC4400450                  | 450  | 685  | 14,30 |  |
| HMC4350500                  | 500  | 735  | 13,95 |       |    |     |    |      |     |    |      |               |               | HMC4400500                  | 500  | 735  | 15,26 |  |
| HMC4350550                  | 550  | 785  | 14,81 |       |    |     |    |      |     |    |      |               |               | HMC4400550                  | 550  | 785  | 16,21 |  |
| HMC4350600                  | 600  | 835  | 15,64 |       |    |     |    |      |     |    |      |               |               | HMC4400600                  | 600  | 835  | 17,16 |  |
| HMC4350700 <b>NEW!</b>      | 700  | 935  | 17,43 |       |    |     |    |      |     |    |      |               |               | HMC4400700 <b>NEW!</b>      | 700  | 935  | 19,20 |  |
| HMC4350800                  | 800  | 1035 | 18,99 |       |    |     |    |      |     |    |      |               |               | HMC4400800                  | 800  | 1035 | 20,97 |  |
| HMC4351000                  | 1000 | 1235 | 22,34 |       |    |     |    |      |     |    |      |               |               | HMC4401000                  | 1000 | 1235 | 24,78 |  |
| <b>ØD 92 ØAL 80 ØS 40</b>   |      |      |       |       |    |     |    |      |     |    |      |               |               | <b>ØD 92 ØAL 80 ØS 50</b>   |      |      |       |  |
| HMC5400200                  | 200  | 474  | 13,54 |       |    |     |    |      |     |    |      |               |               | HMC5500200                  | 200  | 474  | 14,69 |  |
| HMC5400250                  | 250  | 524  | 14,67 |       |    |     |    |      |     |    |      |               |               | HMC5500250                  | 250  | 524  | 16,09 |  |
| HMC5400300                  | 300  | 574  | 15,79 |       |    |     |    |      |     |    |      |               |               | HMC5500300                  | 300  | 574  | 17,50 |  |
| HMC5400400                  | 400  | 674  | 18,05 |       |    |     |    |      |     |    |      |               |               | HMC5500400                  | 400  | 674  | 20,30 |  |
| HMC5400500                  | 500  | 774  | 20,29 | 1/2"  | 40 | 94  | 28 | 47   | 94  | 28 | 47   | CAGEG09406240 | CAGEG09406240 | HMC5500500                  | 500  | 774  | 23,11 |  |
| HMC5400600                  | 600  | 874  | 22,55 |       |    |     |    |      |     |    |      |               |               | HMC5500600                  | 600  | 874  | 25,92 |  |
| HMC5400700 <b>NEW!</b>      | 700  | 974  | 24,80 |       |    |     |    |      |     |    |      |               |               | HMC5500700 <b>NEW!</b>      | 700  | 974  | 28,72 |  |
| HMC5400800                  | 800  | 1074 | 27,05 |       |    |     |    |      |     |    |      |               |               | HMC5500800                  | 800  | 1074 | 31,53 |  |
| HMC5401000                  | 1000 | 1274 | 31,55 |       |    |     |    |      |     |    |      |               |               | HMC5501000                  | 1000 | 1274 | 37,14 |  |
| <b>ØD 105 ØAL 90 ØS 50</b>  |      |      |       |       |    |     |    |      |     |    |      |               |               |                             |      |      |       |  |
| HMC090500300                | 300  | 580  | 21,79 |       |    |     |    |      |     |    |      |               |               |                             |      |      |       |  |
| HMC090500400                | 400  | 680  | 25,13 |       |    |     |    |      |     |    |      |               |               |                             |      |      |       |  |
| HMC090500500                | 500  | 780  | 28,46 |       |    |     |    |      |     |    |      |               |               |                             |      |      |       |  |
| HMC090500600                | 600  | 880  | 31,79 |       |    |     |    |      |     |    |      |               |               |                             |      |      |       |  |
| HMC090500700 <b>NEW!</b>    | 700  | 980  | 35,12 | 1/2"  | 40 | 94  | 28 | 47   | 94  | 28 | 47   | CAGEG09406240 | CAGEG09406240 |                             |      |      |       |  |
| HMC090500800                | 800  | 1080 | 38,46 |       |    |     |    |      |     |    |      |               |               |                             |      |      |       |  |
| HMC090501000                | 1000 | 1280 | 45,12 |       |    |     |    |      |     |    |      |               |               |                             |      |      |       |  |
| <b>ØD 115 ØAL 100 ØS 50</b> |      |      |       |       |    |     |    |      |     |    |      |               |               | <b>ØD 115 ØAL 100 ØS 60</b> |      |      |       |  |
| HMC6500200                  | 200  | 530  | 24,79 |       |    |     |    |      |     |    |      |               |               |                             |      |      |       |  |
| HMC6500250                  | 250  | 580  | 26,55 |       |    |     |    |      |     |    |      |               |               |                             |      |      |       |  |
| HMC6500300                  | 300  | 630  | 28,30 |       |    |     |    |      |     |    |      |               |               |                             |      |      |       |  |
| HMC6500400                  | 400  | 730  | 31,82 |       |    |     |    |      |     |    |      |               |               |                             |      |      |       |  |
| HMC6500500                  | 500  | 830  | 35,34 | 1/2"  | 50 | 120 | 35 | 60   | 120 | 35 | 60   | CAGEG12007550 | CAGEG12007550 | HMC6600300                  | 300  | 630  | 30,46 |  |
| HMC6500600                  | 600  | 930  | 38,86 |       |    |     |    |      |     |    |      |               |               | HMC6600400                  | 400  | 730  | 34,65 |  |
| HMC6500700 <b>NEW!</b>      | 700  | 1030 | 42,37 |       |    |     |    |      |     |    |      |               |               | HMC6600500                  | 500  | 830  | 38,84 |  |
| HMC6500800                  | 800  | 1130 | 45,78 |       |    |     |    |      |     |    |      |               |               | HMC6600600                  | 600  | 930  | 43,04 |  |
| HMC6501000                  | 1000 | 1330 | 52,93 |       |    |     |    |      |     |    |      |               |               | HMC6600700 <b>NEW!</b>      | 700  | 1030 | 47,23 |  |
|                             |      |      |       |       |    |     |    |      |     |    |      |               |               | HMC6600800                  | 800  | 1130 | 51,32 |  |
|                             |      |      |       |       |    |     |    |      |     |    |      |               |               | HMC6601000                  | 1000 | 1330 | 59,82 |  |

MATERIALE TUBO: ACCIAIO St 52.3 DIN 2393 ISO H9  
TUBE MATERIAL : STEEL St 52.3 DIN 2393 ISO H9

MATERIALE ASTA: ACCIAIO UNI C45 SAE 1045 CROMO 25 µm ±5 Rating 9 / 200h ISO 10289 - 1999/ISO 9227-NSS  
ROD MATERIAL : STEEL UNI C45 SAE 1045 CHROME 25 µm ±5 Rating 9 / 200h ISO 10289 - 1999/ISO 9227-NSS



www.hydrotruck.cz  
info@hydrotruck.cz

Hydrotruck s.r.o.  
Tovačovská 3457/4a  
750 02, Přerov  
Česká republika

CARATTERISTICHE TECNICHE  
TECHNICAL SPECIFICATIONS

FORZA IN SPINTA - OUTPUT FORCE    FORZA IN TIRO - INPUT FORCE

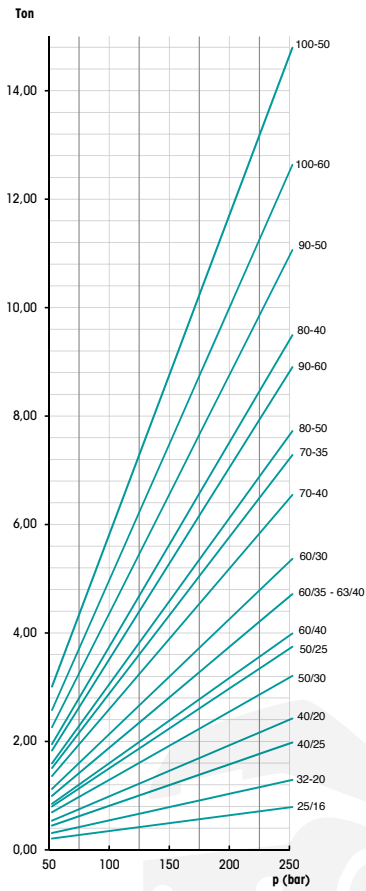
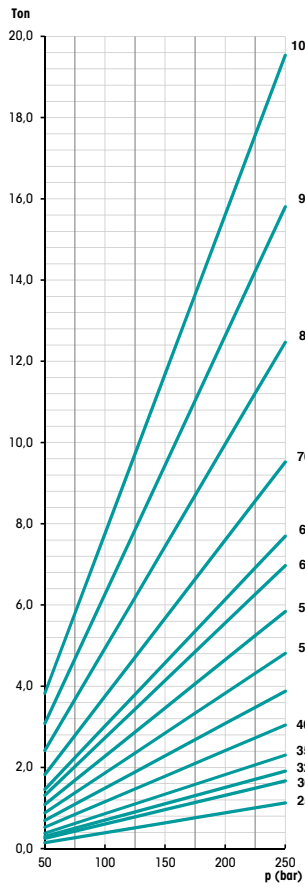

PRESSOFLESSIONE - BUCKLING ( HM1 )

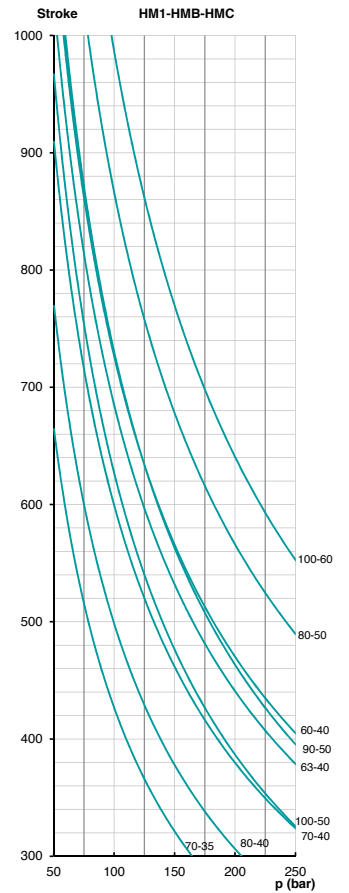
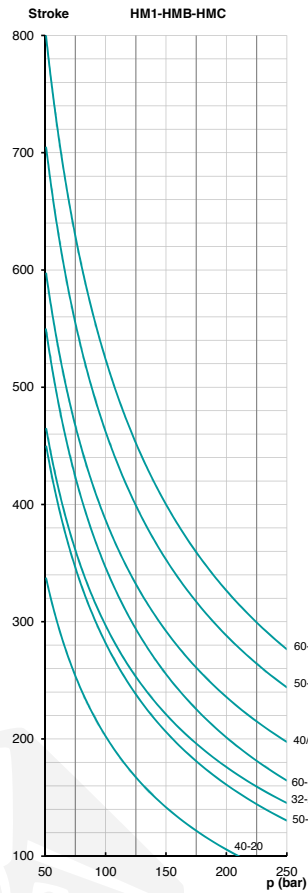

PRESSOFLESSIONE - BUCKLING ( HM2- HM5 )

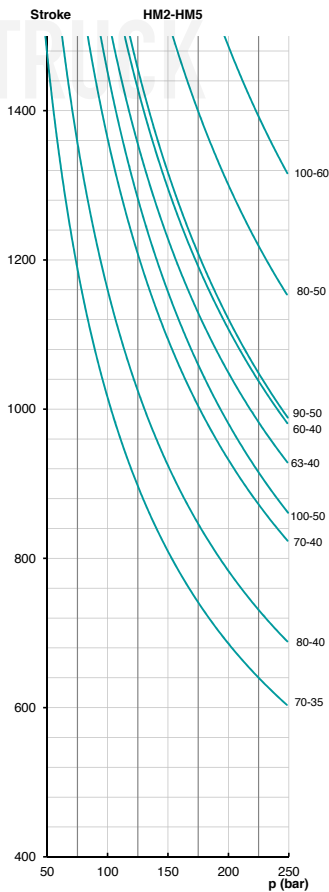
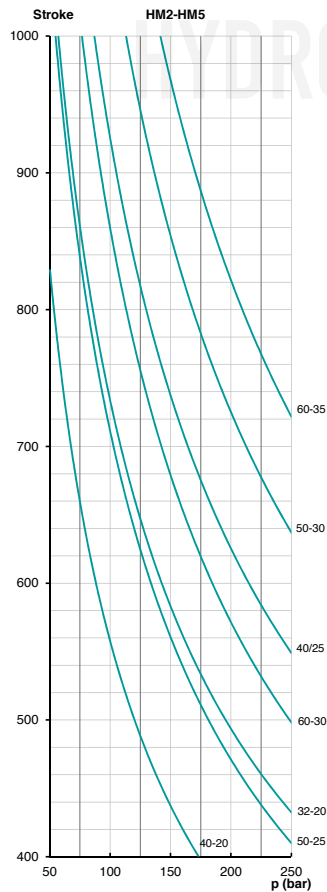

## CARATTERISTICHE TECNICHE TECHNICAL SPECIFICATIONS

### TYPE "HMB"

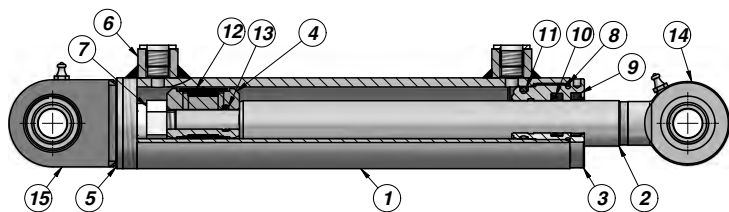

Pressione Massima - Max. Pressure: 250 Bar (\*\*)

### TYPE "HMC"

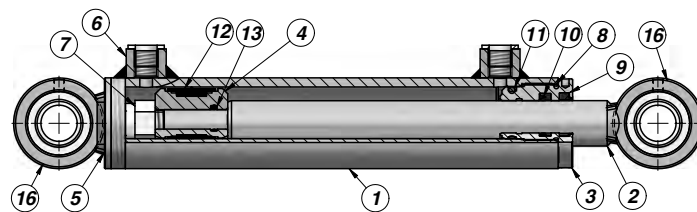

Pressione Massima - Max. Pressure: 250 Bar (\*\*)

| PRODOTTO - PRODUCT |   | MATERIALE - MATERIAL  |  |
|--------------------|---|---|--|
| 1                  | TUBO LUCIDO<br>POLISHED TUBE  | ACCIAIO: St 52.3 DIN 2393 ISO H9<br>STEEL: St 52.3 DIN 2393 ISO H9  |  |
| 2                  | STELO CROMATO<br>CHROMED ROD  | ACCIAIO: UNI C45 - SAE 1045 - CROMO 25 µm ±5 Rating 9 / 200h (<ø20 120h)<br>ISO 10289 - 1999/ISO 9227-NSS<br>STEEL: UNI C45 - SAE 1045 - CHROME 25 µm ±5 Rating 9 / 200h (<ø20 120h)<br>ISO 10289 - 1999/ISO 9227-NSS |  |
| 3                  | TESTATA DI GUIDA<br>HEAD BUSH   | GHISA: EN-GJL 250 ( G25-UNI 5007 / EN 1561 )<br>HYDRAULIC CAST IRON: EN-GJL 250 ( G25-UNI 5007 / EN 1561 )  |  |
| 4                  | PISTONE<br>PISTON   | ACCIAIO: 9SMn28<br>STEEL: 9SMn28  |  |
| 5                  | FONDELLO<br>END PLUG  | ACCIAIO: S355J0 (Fe510C) - S355JR (A105)<br>STEEL: S355J0 (Fe510C) - S355JR (A105)  |  |
| 6                  | BORCHIA FILETTATA<br>THREADED PORT  | ACCIAIO<br>STEEL  |  |
| 7                  | DADO AUTOBLOCCANTE<br>LOCKNUT   | ACCIAIO: UNI 7473 - 7474<br>STEEL: UNI 7473 - 7474  |  |
| 8                  | GUARNIZIONE: O-RING<br>SEAL: O-RING                                       | NBR 70 SHORE<br>NBR 70 SHORE  |  |
| 9                  | GUARNIZIONE: GHK<br>SEAL: GHK   | POLIURETANO<br>POLYURETHANE   |  |
| 10                 | GUARNIZIONE: TSE-TTS-TT/L<br>SEAL: TSE-TTS-TT/L                           | TSE: NBR+TESSUTO TTS-TT/L: POLIURETANO<br>TSE: NBR+FABRIC TTS-TT/L: POLYURETHANE  |  |
| 11                 | GUARNIZIONE: O-RING<br>SEAL: O-RING                                       | NBR 70 SHORE<br>NBR 70 SHORE  |  |
| 12                 | GUARNIZIONE: TPM<br>SEAL: TPM   | NBR+POM+TPE<br>NBR+POM+TPE  |  |
| 13                 | GUARNIZIONE: O-RING<br>SEAL: O-RING                                       | NBR 70 SHORE<br>NBR 70 SHORE  |  |
| 14                 | TERMINALE A SNODO RILUBRIFICABILE<br>BALL-JOINT END WITH GREASE NIPPLE    | TIPO : "CSTS...C" ACCIAIO: ISO 12240-4 SERIE E - TIPO S<br>TYPE : "CSTS...C" STEEL: ISO 12240-4 SERIES E - TYPE S   |  |
| 15                 | TERMINALE A SNODO RILUBRIFICABILE<br>BALL-JOINT END WITH GREASE NIPPLE    | TIPO : "CSTS...N" ACCIAIO: ISO 12240-1 SERIE E<br>TYPE : "CSTS...N" STEEL: ISO 12240-1 SERIES E   |  |
| 16                 | ANELLO A SILDARE CON SNODO "GE" MONTATO<br>WELD-RING WITH "GE" BALL-JOINT | TIPO : "CAGEG" ACCIAIO: S355J0 (Fe510C) - S355JR (A105)<br>TYPE : "CAGEG" STEEL: S355J0 (Fe510C) - S355JR (A105)  |  |

Velocità Limite - Top Speed: max 0,5 m/s Temperatura C° - Temperature C°: -25°C - +80°C

(\*\*) Il dato della pressione è sempre da verificare in base all'applicazione del cilindro.

(\*\*) The pressure value is always to be checked depending on the application of the cylinders.



[www.hydrotruck.cz](http://www.hydrotruck.cz)  
[info@hydrotruck.cz](mailto:info@hydrotruck.cz)

Hydrotruck s.r.o.  
Tovačovská 3457/4a  
750 02, Přerov  
Česká republika