



Pinze per la movimentazione di tronchi, per un'ottimale presa del carico, in completa sicurezza.
 Log grabs with appropriate grabbing power, working in the safest conditions.

Modelli Models	Peso Weight	Portata Load capacity	Area	Forza Force	Pressione Pressure	Ø A min	Ø A max	B	C	D	E	F	Rotatore consigliato Suggested rotator
	kg	kg	m ²	Kn	bar	mm	mm	mm	mm	mm	mm	mm	type
FLG 15 L COMPACT	60	1000	0,15	12	250	65	405	460	310	730	1000	700	FR 15

In conformità EN 2006 42 CE - ISO 4413:2012 - According to EN 2006 42 EC - ISO 4413:2012
 In conformità EN 12100:2010 - According to EN 12100:2010

Valvola di blocco montata standard
 Block valve mounted as standard

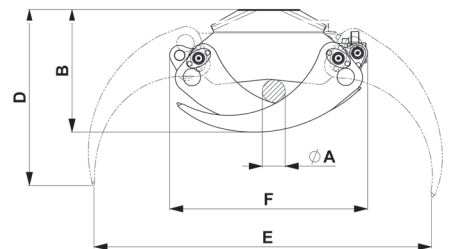
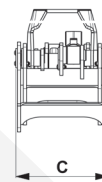

-  PINZE AGROFORESTALI
-  FMF AGRICULTURAL GRABS
-  PINCES AGROFORESTIERES
-  FMF-LANDWIRTSCHAFTLICHE GREIFER

-  PINZAS AGROFORESTALES
-  КЛЕЩЕБЫЕ ЗАХВАТЫ
-  农林复合抓头
-  كباشات زراعية



Pinze agroforestali a cilindro orizzontale, per la movimentazione di materiale organico e altri materiali.
 Agricultural grabs with horizontal cylinder, for handling different materials.

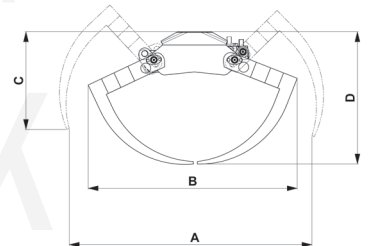

Modelli Models	Denti Teeth	Peso Weight	Portata Load capacity	Pressione Pressure	A	B	C	D	E	Tipo gru Crane type	Tipo escavatore Excavator type	Rotatore consigliato Suggested rotator
	n°	kg	kg	bar	mm	mm	mm	mm	mm	ton.	ton.	type
FMF 06	6	110	800	250	1400	960	510	690	400	0,2 - 0,4	2,0 - 3,0	FR 35 - FR 35F
FMF 08	8	130	1000	250	1400	960	510	690	500	0,4 - 0,6	3,0 - 4,0	FR 35 - FR 35F
FMF 10	10	145	1000	250	1400	960	510	690	650	0,4 - 0,9	3,0 - 7,0	FR 35 - FR 35F
FMF 12	12	165	1000	250	1400	960	510	690	800	0,6 - 1,0	4,0 - 8,0	FR 50 - FR 55F
FMF 14	14	185	1000	250	1400	960	510	690	950	0,8 - 1,5	5,0 - 9,0	FR 50 - FR 55F
FMF 16	16	205	1000	250	1400	960	510	690	1100	1,0 - 1,8	6,0 - 10,0	FR 50 - FR 55F

In conformità EN 2006 42 CE - ISO 4413:2012 - According to EN 2006 42 EC - ISO 4413:2012
 In conformità EN 12100:2010 - According to EN 12100:2010

Valvola di blocco optional - Optional block valve

